

Imaging Unit Cleaning Tool Instruction Sheet

1

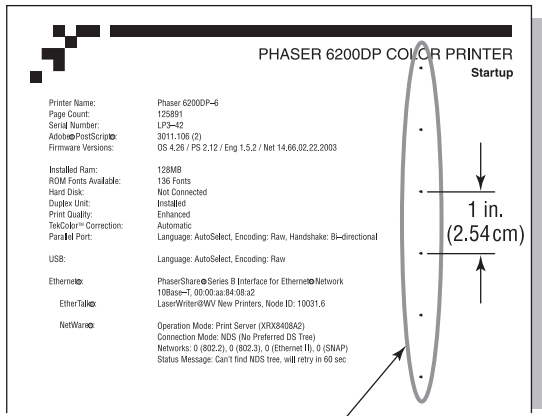

Print a Startup Page and look for repeating spots. Confirm spacing of defects appear every inch (2.54 cm) and run the length of the page.

2

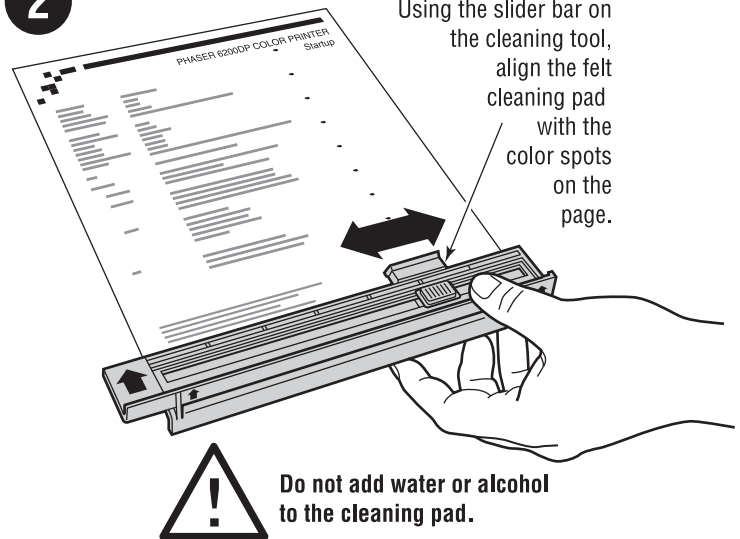

Using the slider bar on the cleaning tool, align the felt cleaning pad with the color spots on the page.

Do not add water or alcohol to the cleaning pad.

3

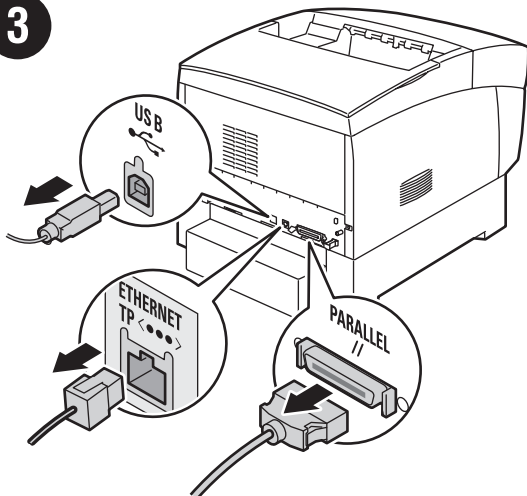

Remove all interface cables from the printer.

4

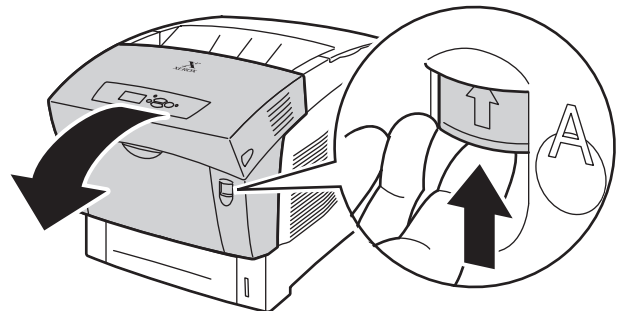

5

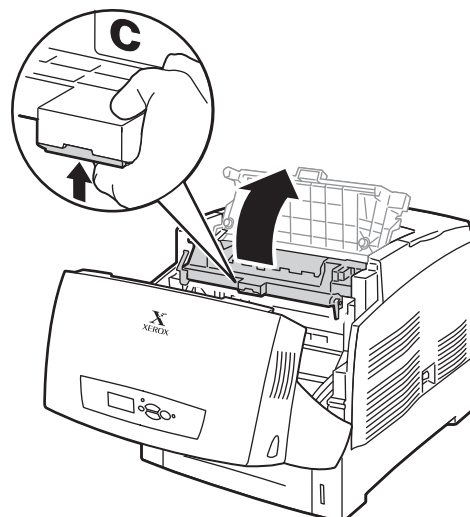

6



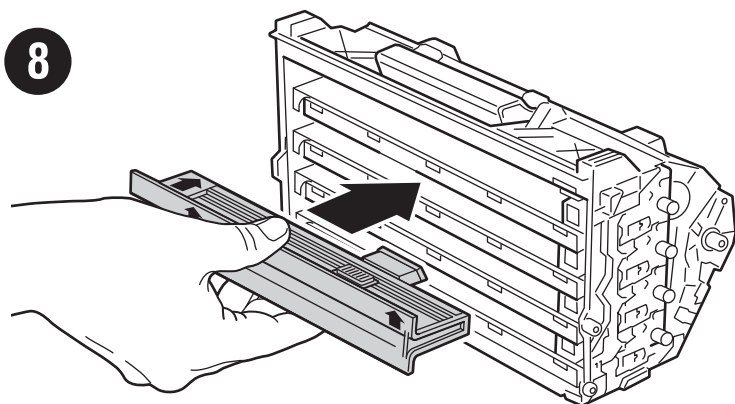
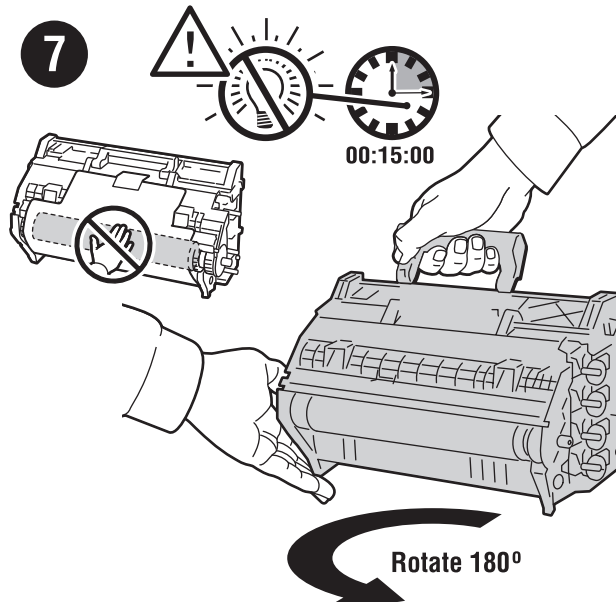
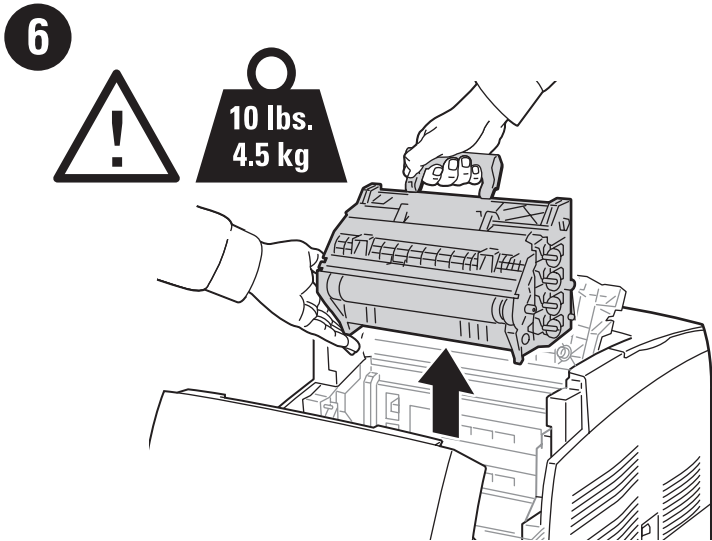

Match the color of the repeating spot with the slot in the image unit (cyan and magenta are usually the problem). Do not install the tool in the yellow slot.

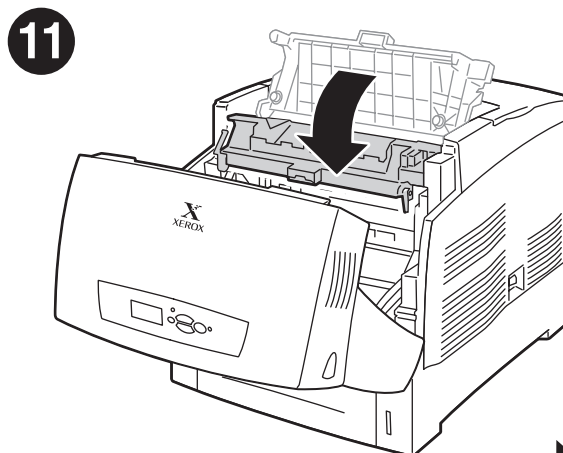
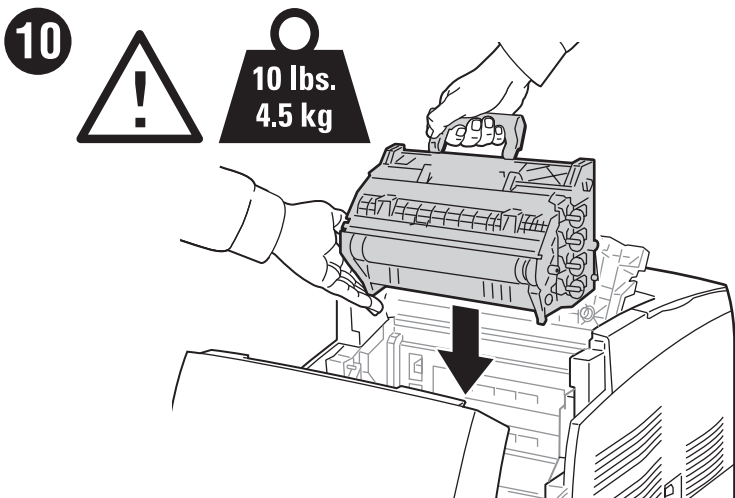
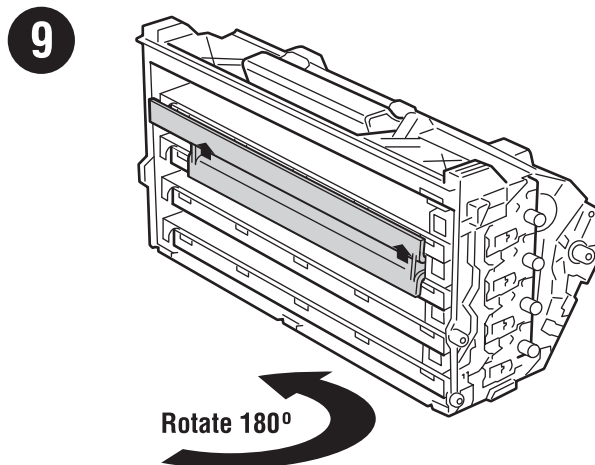
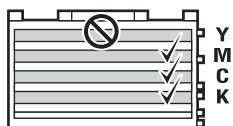

12

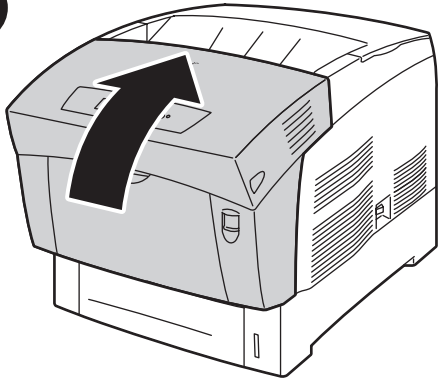

Close door A. Wait approx. 15 to 20 seconds.
 "Ready to Print" displays on the front panel
 when cleaning is complete.

13

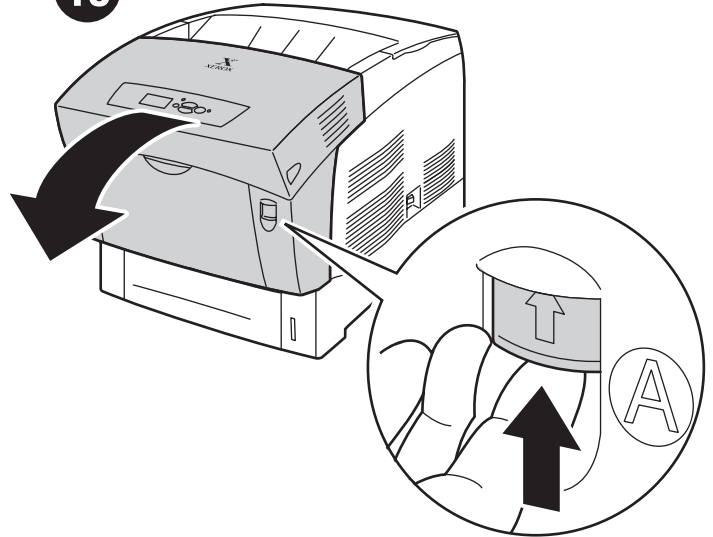

14

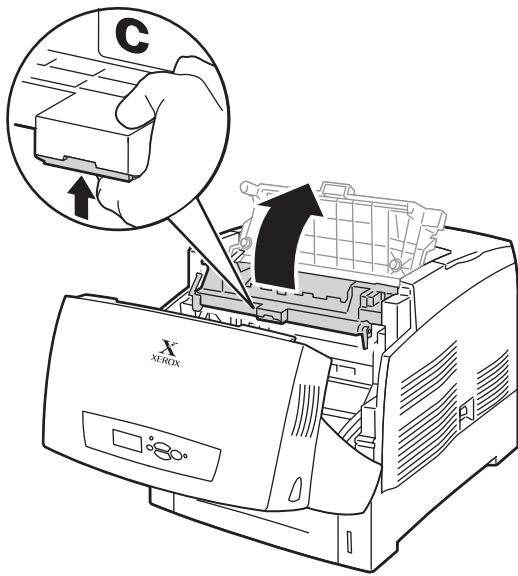

15

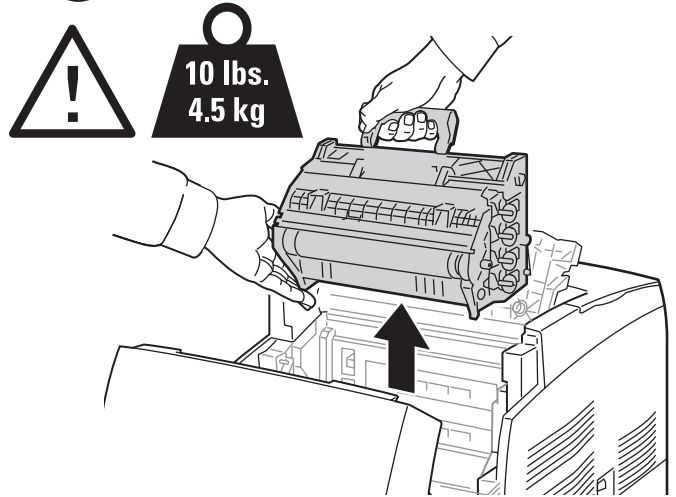

16

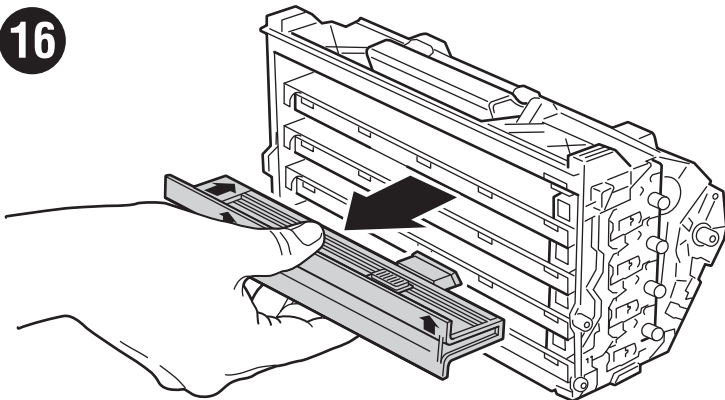

17

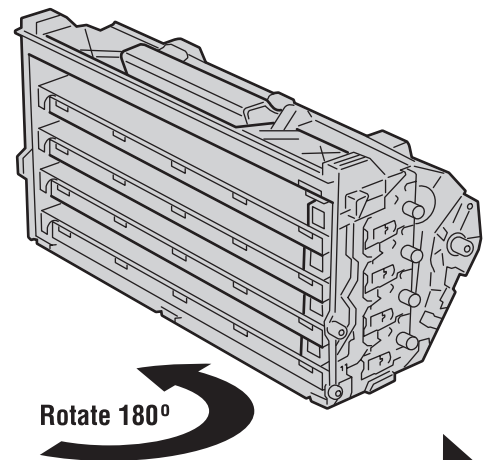

Rotate 180°

18

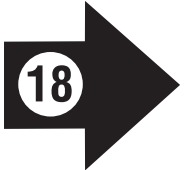

18

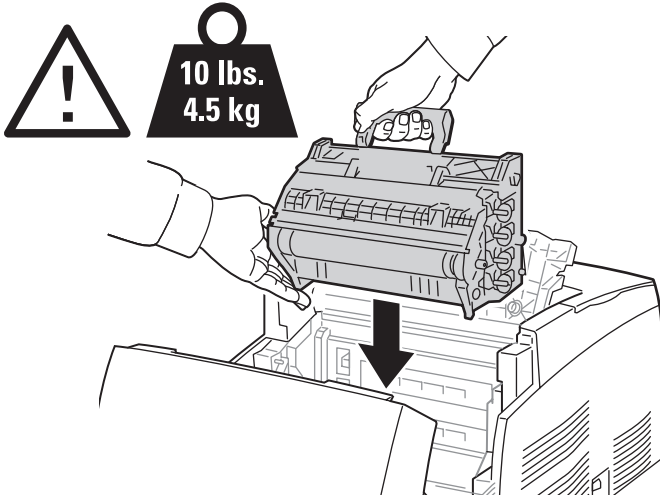

19

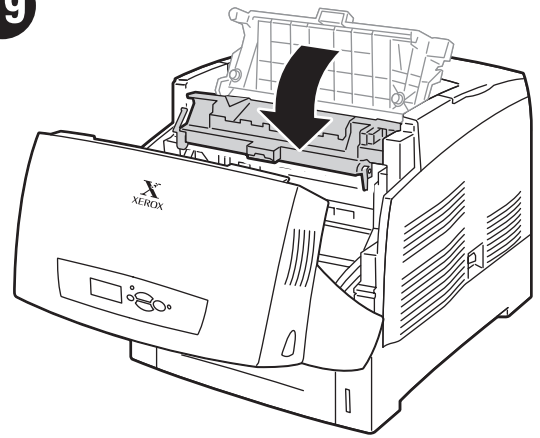

20

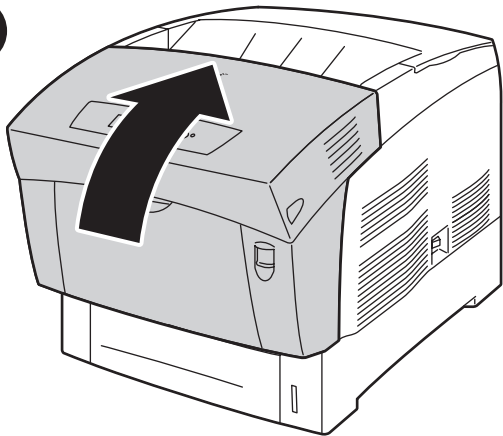

21

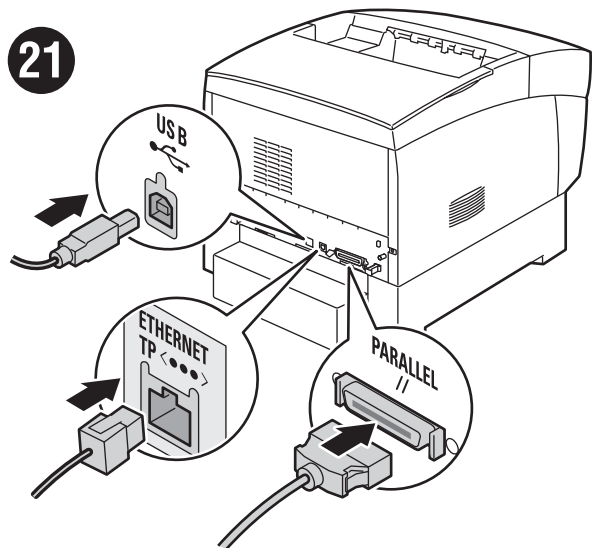

Re-install all interface cables to the printer. Print a Startup Page again. Check for defect to be eliminated. If defect is still found, repeat procedure from step 3 on.

22

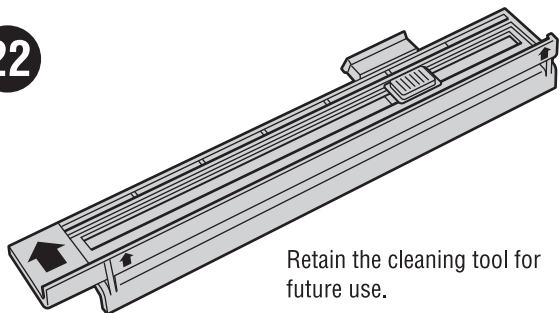

Retain the cleaning tool for future use.